

PROPOSED (G+4) STORIED RESIDENTIAL CUM COMMERCIAL BUILDING AT
MOUZA - CHAKRAGHATA, J.L. NO. -26, C.S. DAG NO. 450(P), R.S. DAG NO.
387(P), L.O.P. -326(A), 326(B), 326(C), 326(D), WARD NO. 23, HOLDING NO.
40, BIRESH PALLY (NORTH), P.S. - MADHYAMGRAM, DIST. NORTH 24
PARGANAS, UNDER MADHYAMGRAM MUNICIPALITY

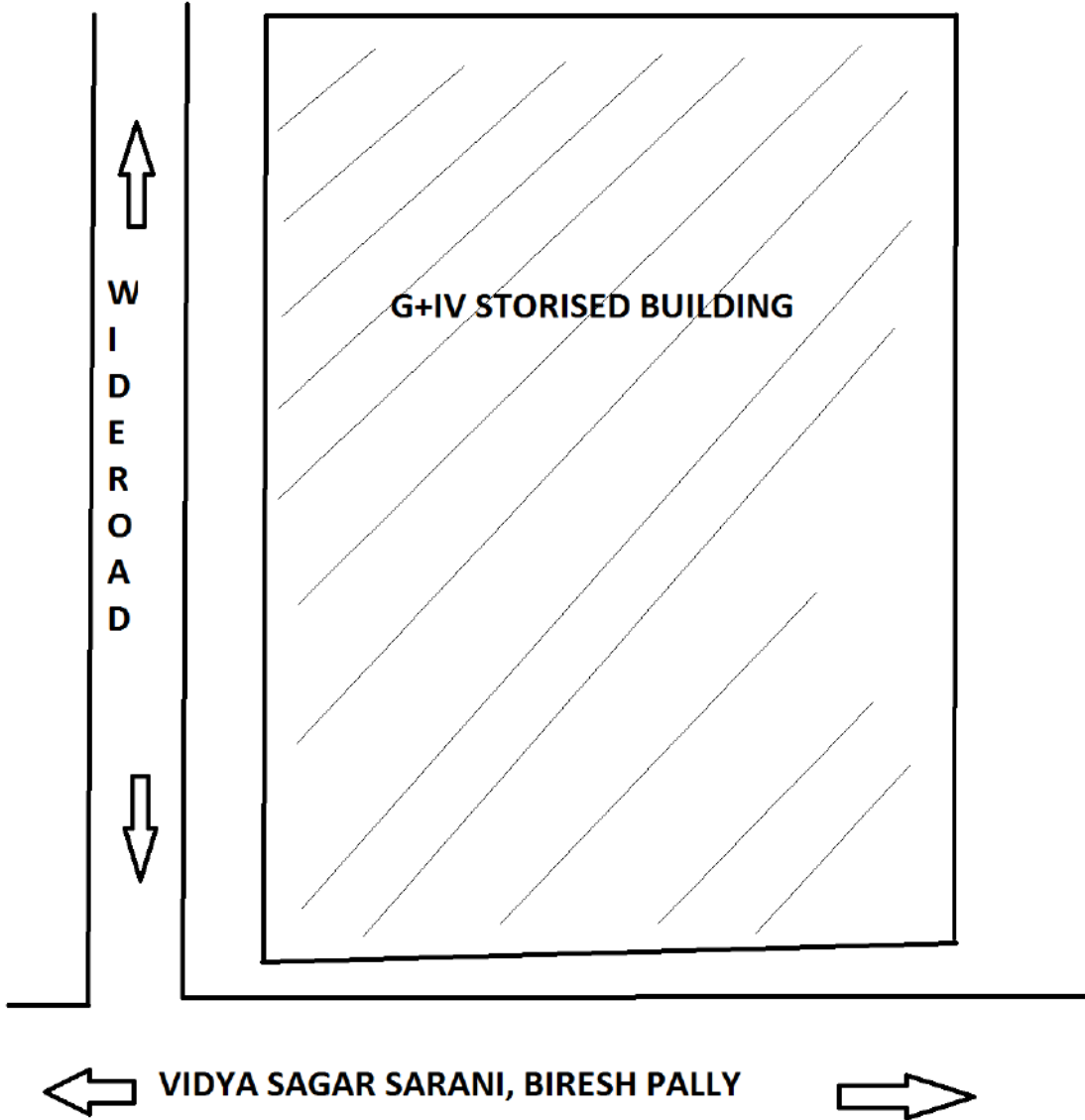

LATITUDE : 22.692250
LONGITUDE : 88.456563

R. J. CONSTRUCTION
Rajiv Biswas
Partner

SIGNTURE OF OWNER